

Exterior Windows

Storm window sizes are determined by measuring your existing window opening as shown below. Record smallest opening width A first and opening height B second. Round down to the nearest 1/8".

Storm Windows can be installed Outside Mount or Inside Mount, or you can have the windows made to the exact tip-to-tip measurement desired.

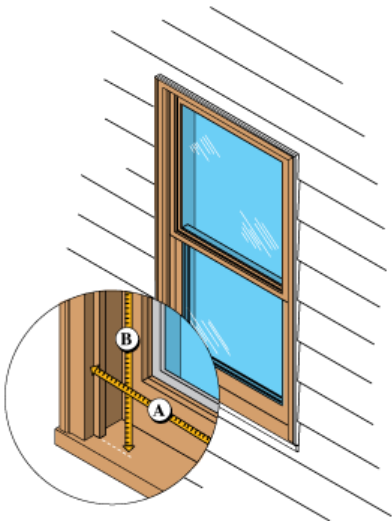

OUTSIDE MOUNT
Overlap

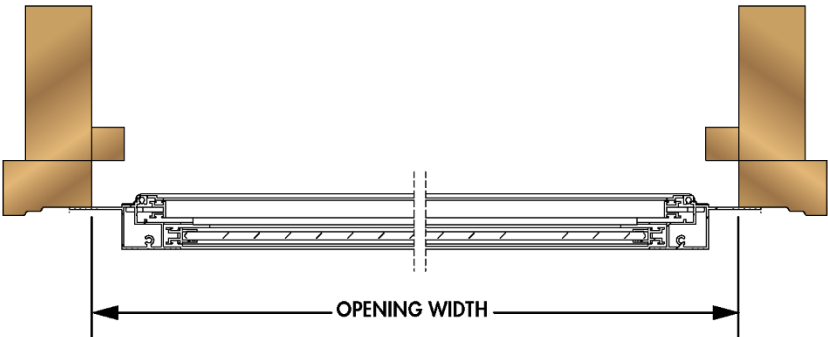

INSIDE MOUNT
Opening Size/Blindstop

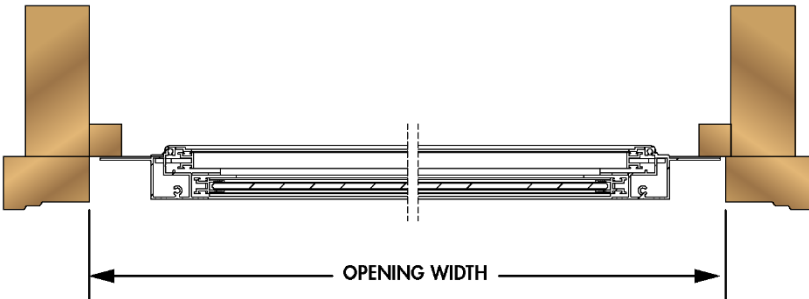

Ordering Your Exterior Storm Window

Outside Mount Installation

Overlap

Measure your existing window opening listing width first and height second. One inch will automatically be added to the width and 3/4" to the height allowing an overlap for a proper fit.

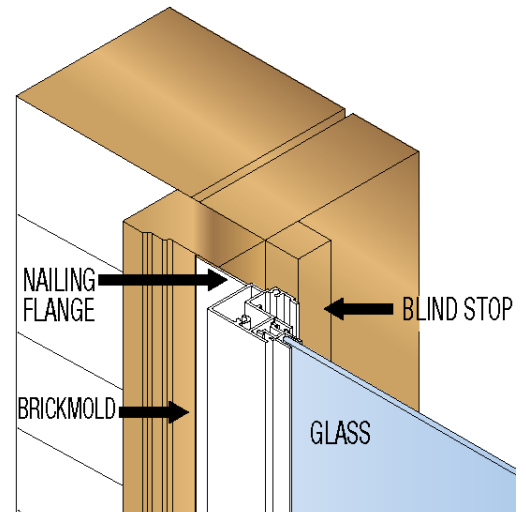

Inside Mount Installation

Opening Size/Blindstop

Measure your existing window opening listing width first and height second. The window will be automatically downsized to ensure proper clearance and fit.

